

# 3-Way Directional Control Valves

▼ Shown from left to right: VE32D, VE33, VC-3L, VM33L, VM32



- User adjustable relief valves on VM- and VE-Series allow the operator to easily set the working pressure for each application
- All VM- and VE-series valves feature several gauge ports for "system", A and B port pressure monitoring
- All valves (except VM32, VE32D and VC-Series) include manifold with built-in "System Check" feature, for more precise pressure holding and improved system control
- VM33 has improved porting for faster cylinder retraction while pump motor is running
- Manual or solenoid operation.



◀ A typical multi-cylinder control set-up using solenoid directional control valves.

## For Reliable Control of Single-Acting Cylinders



### Valving Help

See Basic System Set-Up and Valve Information in our 'Yellow Pages'.

Page: 122

Valve Operation	Valve Location	Valve Type	
Manual	Pump Mounted	3-way, 2-position	
Manual	Pump Mounted	3-way, 3-position, Tandem Center	
Manual	Pump Mounted	3-way, 3-position, Tandem Center, Locking <sup>1)</sup>	
Manual	Remote Mounted <sup>3)</sup>	3-way, 3-position Tandem Center	
Manual	Remote Mounted <sup>3)</sup>	3-way, 3-position Tandem Center, Locking <sup>1)</sup>	
Manual	Remote Mounted <sup>3)</sup>	3-way, 3-position Closed Center	
Manual	Remote Mounted <sup>3)</sup>	3-way, 3-position Closed Center, Locking <sup>1)</sup>	
Solenoid 24 VDC	Pump Mounted	3-way, 2-position <sup>2)</sup>	
Solenoid 24 VDC	Pump Mounted	3-way, 2-position Dump	
Solenoid 24 VDC	Pump Mounted	3-way, 3-position Tandem Center	

<sup>1)</sup> with pilot-operated check valve.

<sup>2)</sup> VE32 provides "HOLD" function by turning off pump and holding pressure against system check.

# 3-Way Directional Control Valves

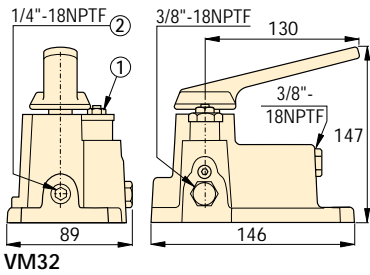

VM32

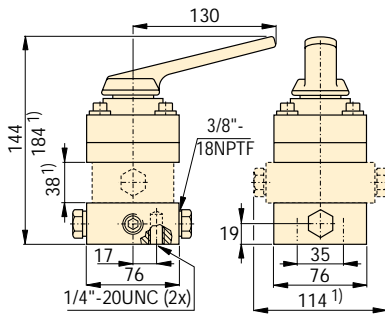

VC-3, VC-3L, VC-15, VC-15L

<sup>1)</sup> VC-3L and VC-15L only

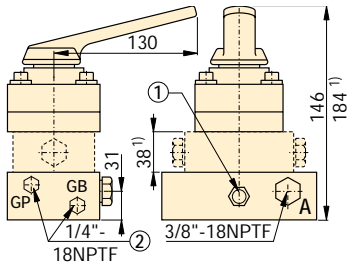

VM33, VM33L <sup>1)</sup> for VM33L only

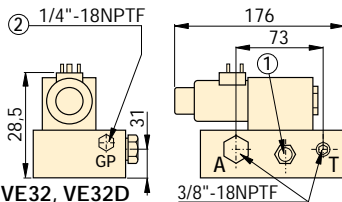

VE32, VE32D

- ① adjustable relief valve    ② auxiliary ports

## VC VE VM Series



Flow Capacity:  
**17 l/min**

Maximum Operating Pressure:  
**700 bar**

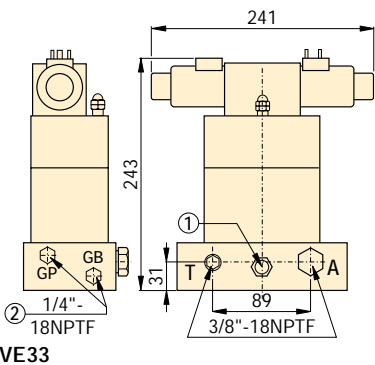

VE33

Model Number	Hydraulic Symbol	Schematic Flowpath			Weight (kg)
		Advance	Hold	Retract	
VM32					2,5
VM33					3,0
VM33L					4,8
VC-3 <sup>3)</sup>					2,9
VC-3L <sup>3)</sup>					4,7
VC-15 <sup>3)</sup>					2,9
VC-15L <sup>3)</sup>					4,7
VE32					3,9
VE32D					3,9
VE33					9,2

<sup>3)</sup> VC-Series remote valves include Return line kit VRL-10.



### Locking Valves

For applications requiring positive load holding, VM- and VC-Series valves (except VM32) are available with a pilot-operated check valve. This provides hydraulic locking of the load until the valve is shifted into the retract position. To order this feature, place an "L" at the end of the model number.



### Pendants for VE-Series Solenoid Valves

When ordering Enerpac VE-Series solenoid valves, the pendant must be ordered separately. Pendant connection to be plugged into electric box of pump.

To be used with solenoid valves:	Pendant Model Nr.
VE32D	ZCP-1
VE32, VE33	ZCP-3